



INFO GUIDE #2

Transplanting Cannabis Seedlings Into Jiffy Pellets

If your initial germination process was successful, it's time to move your cannabis seedlings into jiffy pellets. The goal of this process is to provide new sprouts with a medium in which they can establish a small, but strong root zone.

Step #1: Soak Jiffy Pellets

Begin the process by preparing a nutrient solution of B vitamins and water. After the nutrient solution is prepared, toss your Jiffy pellets in to soak. Wait 5-10 minutes for the Jiffy's to adequately absorb the nutrient solution. You can check if your Jiffy's are prepared by gently squeezing the outside of the pellet.

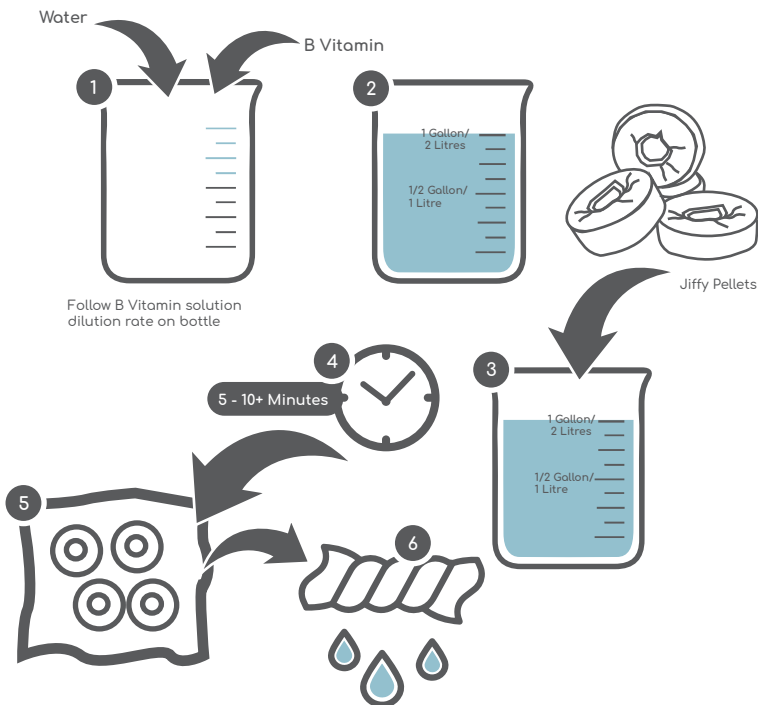

Step #2: Transplanting Seedlings Into Jiffy Pellets

Examine each sprout: if the taproot is at least $\frac{1}{4}$ " long, they are ready to be transplanted into jiffy pellets. Carefully take each seedling and place them in their respective pellet with the taproot facing down. Finally, gently cover the seed shell in a small amount of soil.

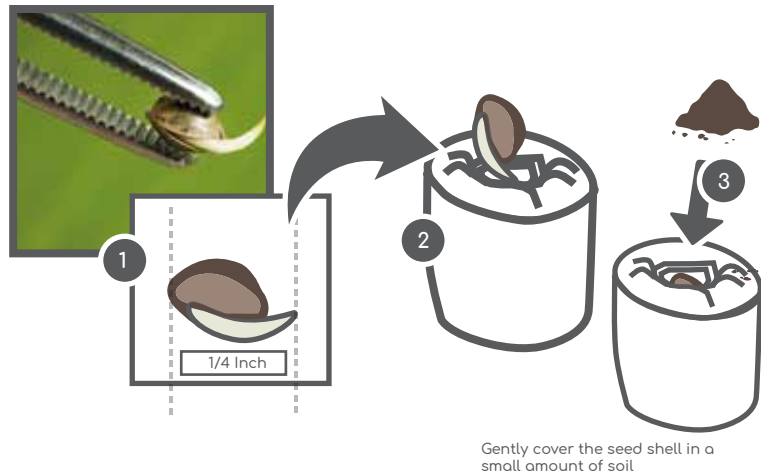

Step #3: Place Seedlings in a Germination Tray and Dome

Take your expanded jiffy pellets and place them in a standard 10" x 20" germination tray. Then, cover them with an appropriate 4" or 7" humidity dome. Since your seedlings will be living in this tray for the next 10-14 days, there are several tools available to help manage and control the environment.

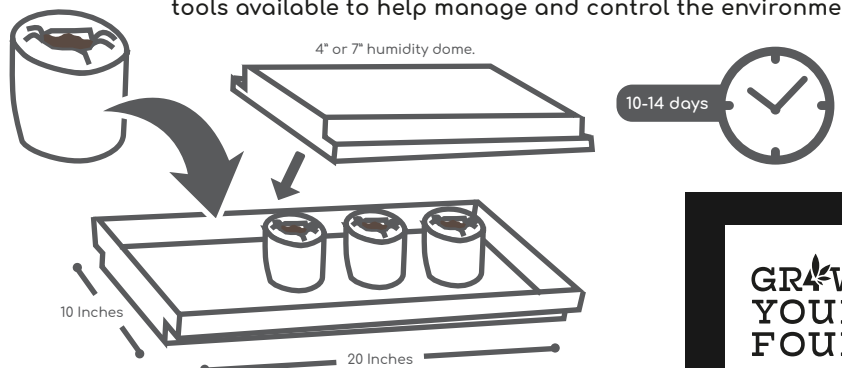

GR4W
YOUR
FOUR



INFO GUIDE #2

Transplanting Cannabis Seedlings Into Jiffy Pellets



Lighting: Choose a low wattage, low-intensity light source. T5 fluorescents or LED lighting is a great option to consider. At this stage, the light source is only there to encourage upward movement, not vigorous growth.



Heat Mat: A heating mat's purpose is to raise the temperature of a small space to an adequate level. Especially during the colder seasons, a heating mat may be essential for providing your seedlings with a constant temperature of at least 70 degrees Fahrenheit (21C).



Digital Monitors: The purpose of a digital thermometer/hygrometer is to measure the constant temperature and humidity of a given space. For the best outcome, attempt to keep your seedlings in an environmental range of 70-75 degrees Fahrenheit (21-24C) and a minimum 70-80% relative humidity.

Step #4: Set It, but Don't Forget It

This period of growth will be slow: in some cases, the transition period can take up to 14 days. So, don't worry if you can't see measurable growth overnight. Set your plants up for success, leave them be, but don't forget them. Monitor your tools, control levels of temperature and humidity, and if necessary, spray your plants with a light solution of B vitamins or liquid seaweed solution.

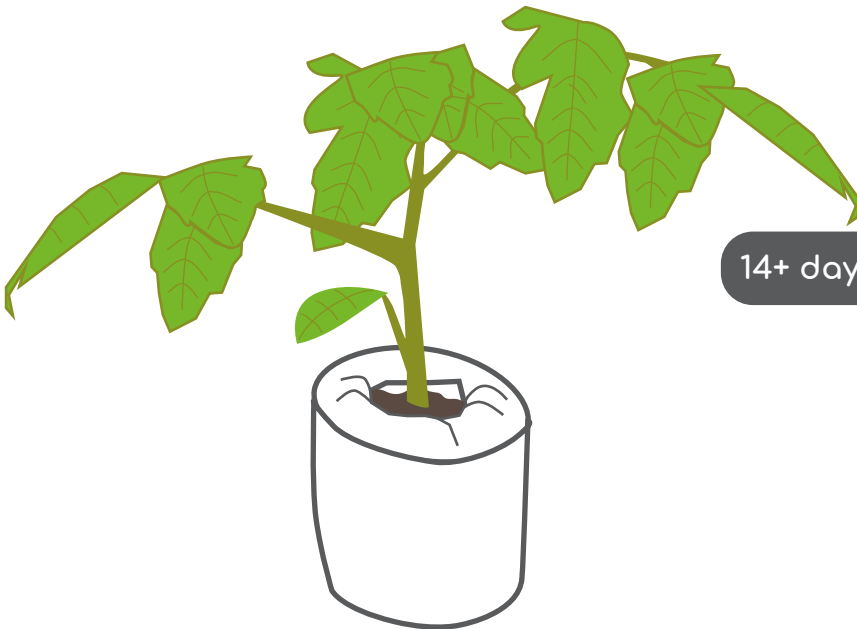

14+ days



SCAN FOR BLOG

CLICK FOR BLOG

**GR4W
YOUR
FOUR**